



**Panel end connector, silver coloured,  
anodized with steel clamping screws**

- Item No. 00.007 3-5mm
- Item No. 00.107 5-8mm
- Item No. 00.207 8-10mm

**Weight: 0,035 kg  
Traction: 20 kg**



**Panel end connector, silver coloured,  
anodized with plastic clamping screws**

- Item No. 01.007 3-5mm
- Item No. 01.107 5-8mm
- Item No. 01.207 8-10mm

**Weight: 0,035 kg  
Traction: 20 kg**

00.007 + 01.007  
00.107 + 01.107

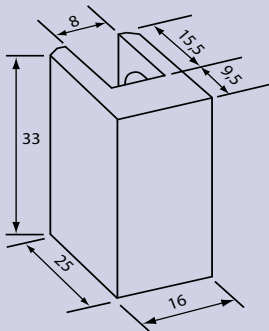

00.207 + 01.207

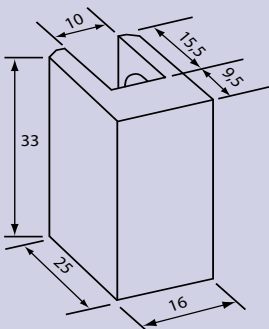

00.007 + 01.007

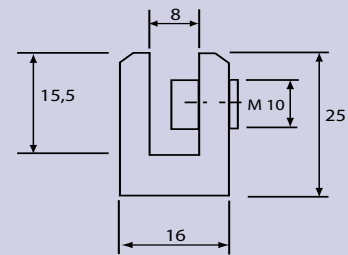

00.107 + 01.107

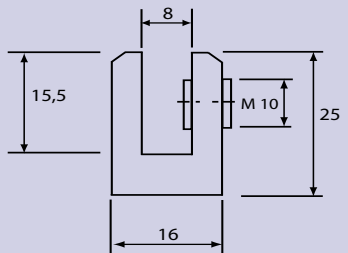

00.207 + 01.207

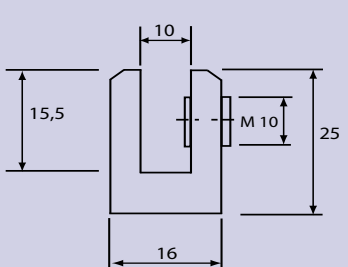

# Technical information



**Panel end connector, silver coloured,  
anodized with steel clamping screws**

- Item No. 00.007 3-5mm**
- Item No. 00.107 5-8mm**
- Item No. 00.207 8-10mm**



**Panel end connector, silver coloured,  
anodized with plastic clamping screws**

- Item No. 01.007 3-5mm**
- Item No. 01.107 5-8mm**
- Item No. 01.207 8-10mm**

Item No.	for panel thickness ( mm )	Material	Surface	Traction
00.007	3 - 5	Aluminium	silver coloured, anodized E6/EV1	~ 20 kg
01.007	3 - 5	Aluminium	silver coloured, anodized E6/EV1	~ 10 kg
00.107	5 - 8	Aluminium	silver coloured, anodized E6/EV1	~ 20 kg
01.107	5 - 8	Aluminium	silver coloured, anodized E6/EV1	~ 10 kg
00.207	8 - 10	Aluminium	silver coloured, anodized E6/EV1	~ 20 kg
01.207	8 - 10	Aluminium	silver coloured, anodized E6/EV1	~ 10 kg