

# Technical information



**Combi-Connector,  
silver coloured, anodized  
with steel clamping screws**

**Item No. 20.311 10-13mm**  
**Item No. 20.411 13-16mm**

**Weight: 0,115 kg**  
**Traction: 30 kg**



**Combi-Connector,  
silver coloured, anodized  
with steel clamping screws**

**Item No. 21.311 10-13mm**  
**Item No. 21.411 13-16mm**

**Weight: 0,115 kg**  
**Traction: 20 kg**

20.311 + 21.311  
20.411 + 21.411

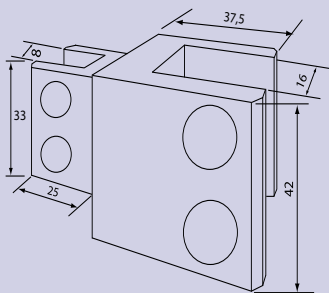

20.311 + 21.311

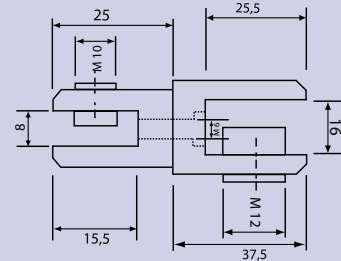

20.411 + 21.411

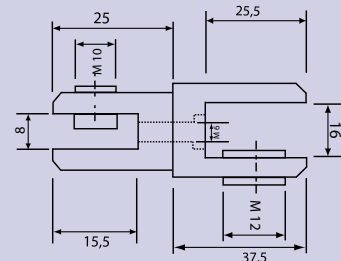

# Technical information



**Combi-Connector,  
silver coloured, anodized  
with steel clamping screws**

**Item No. 20.311 10-13mm  
Item No. 20.411 13-16mm**

**Combi-Connector,  
silver coloured, anodized  
with steel clamping screws**

**Item No. 21.311 10-13mm  
Item No. 21.411 13-16mm**

Item No.	for panel thickness ( mm )	Material	Surface	Traction
20.311	10-13	Aluminium	silver coloured, anodized E6/EV1	~ 30 kg
21.311	10-13	Aluminium	silver coloured, anodized E6/EV1	~ 20 kg
20.411	13-16	Aluminium	silver coloured, anodized E6/EV1	~ 30 kg
21.411	13-16	Aluminium	silver coloured, anodized E6/EV1	~ 20 kg